



The One and Only NanaWall
Opening Glass Walls

Residential Applications

NanaWall
Engineering the Exceptional

NanaWall for All Seasons:

Winter



Park City Residence, Park City UT
NanaWall Folding Glass Wall WA67: aluminum clad wood framed folding system, top-hung system



Spring



Willow Bend, Irvine CA
NanaWall Folding System SL45: standard aluminum framed top-hung folding system



NanaWall for All Seasons:

Summer



Malibu Beach Residence, Malibu CA
NanaWall Folding System SL45: standard aluminum framed
top-hung folding system

Fall



Loblolly House, Taylor's Island MD
NanaWall Folding System SL70: large opening, highly energy
efficient, floor supported aluminum framed system





Reimagining Homes through **Ingenuity**

Burnaby Residence

“We wanted the ability to open the interior to the outdoors and to create a large entertaining area. When the wall is closed, there are no frames and the all glass panels are extremely attractive. We are highly impressed by the NanaWall as it helped us achieve all our design goals.”

—Jason Fediuk, Homeowner

The SL80 has the narrowest frames available and is the most energy efficient aluminum framed folding system in the world.



A Scottsdale Residence, Phoenix AZ
 NanaWall FoldFlat® System SL45: **standard aluminum framed**
top-hung folding system, panels fold flat against the wall

B Coquitlam Residence, British Columbia CA
 NanaWall Folding System SL80: **extremely energy efficient,**
narrow frames, floor supported system

Creating the Unexpected through **Flexibility**

Raleigh Residence, Raleigh NC
NanaWall Folding System SL70: large opening, highly energy efficient, floor supported system



Raleigh Residence

“The NanaWall was a central element to the achievement of a smaller home feeling expansive. The NanaWall visually expanded the perceived space of the main living area so that our “not-so-big house” feels larger than our prior house that was more than twice the size. We could not have achieved our living-large remodel without NanaWall!”

—Greg Kelly, Homeowner



The SL80/81 has the narrowest frame profiles available—and is the most energy efficient aluminum framed folding system in the world.

A La Jolla Residence, La Jolla CA
NanaWall Single Track Sliding System HSW60: **energy efficient individual top-hung sliding aluminum panels, unlimited parking capabilities**

B Sidney Island Residence, Vancouver British Columbia CA
NanaWall Single Track Sliding System HSW60: **energy efficient individual top-hung sliding aluminum panels, unlimited parking capabilities**





Transforming Homes through **Aesthetics**

The Butterfly House

“NanaWall was really part of the concept of the house. In fact, when we were designing our home, it was very clear that NanaWall was the only choice.”

—Suzanne Rinaldo, Homeowner



See Why The Butterfly Homeowners
Call NanaWall “The Only Choice”
nanawall.com/home-owners



A Los Angeles Hills Residence, Los Angeles CA
NanaWall Folding System SL45: standard aluminum framed
top-hung folding system

B Parkville Residence, Vancouver Island British Columbia CA
NanaWall Folding System SL70: large opening,
highly energy efficient, floor supported system

Providing Comfort and Security through **Performance**

Lakeside Residence, Lakeside MI
NanaWall Folding System SL70: large opening, highly energy efficient,
floor supported system



Lake Erie Residence

“Winter on Lake Erie is brutal. Our goal was a 3 season room—we achieved an air tight 4 season room. Last year the NanaWalls passed another test. Hail and 60 mph winds left homes along this lake front with severe window damage. The NanaWalls came through without a scratch. We are very pleased.”

—Barbara and Ralph Daugstrap, Homeowners



Lake Erie Residence, Rocky River OH
NanaWall Folding Glass Wall WA67: aluminum clad wood
framed folding system, top-hung system



As Practical As They Are Beautiful

Our products' design is eye-catching. Premium materials fashioned in clean, sleek lines. Hidden hardware. A choice of solid wood with matching grains, aluminum clad frames, or all aluminum in custom sizes. Yet, when closed, they provide all the comfort and protection of a fixed wall.

- **Quality Craftsmanship:** Every American-made and German engineered NanaWall system is backed by rigorous testing and high-grade materials. The NanaWall brand is an investment that boosts a property's appeal and value.
- **Open and Close with Ease:** Opening and closing a NanaWall is easy. Single handle, one-handed operation quickly opens the panels as the rollers smoothly guide the panels to their open or closed position.
- **Highly Secure:** Secure tamper-resistant locks engage with the turn of a handle creating a secure multipoint connection.

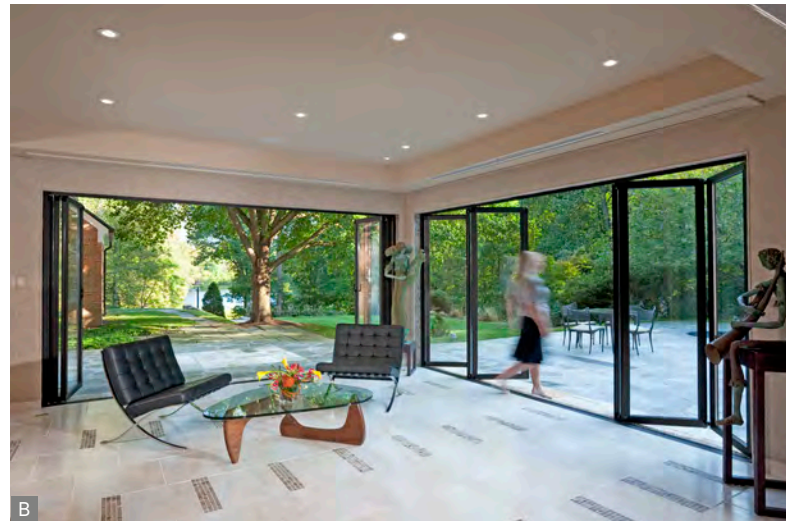

A Painted Lady on Postcard Row, San Francisco CA
NanaWall Folding System SL60: **standard residential system, energy efficient, top-hung or floor supported**

B Potomac Residence, Washington D.C.
NanaWall Folding System SL60: **standard residential system, energy efficient, top-hung or floor supported**

Performance When Closed

The real measure of quality is how an opening glass wall performs when it is closed.



Watch NanaWall in Extreme Conditions
nanawall.com/applications/cold-weather-climates

- **Energy Efficient:** When the NanaWall is closed, the energy efficient design keeps the cold on the outside while maintaining warmth inside—even right up against the glass and frames.
- **Seals out Wind and Rain:** Specialized seals and panel design provides superior humidity and moisture control while our sill designs resist water's ability to enter the home.
- **Extreme Weather Resistance:** When closed, our glass walls form a refuge against extreme weather keeping you comfortable and secure.

A Sooke Residence, B.C. Canada
NanaWall Folding System SL82: **edge-to-edge all glass, minimal visible frames, floor supported system**



B Whistler Residence, Whistler British Columbia CA
NanaWall Folding Glass Wall WA67: **aluminum clad wood framed folding system, top-hung system**

Create Value and Appeal

From New Construction
to Remodeling Projects

Transform traditional sliding glass doors
or fixed walls into flexible openings that
invite the outside in and remove visual
and physical barriers.



Mercer Island Residence, Seattle WA
NanaWall Folding System SL70: large opening, highly energy
efficient, floor supported system



Draw the buyers in by providing an enhanced indoor/outdoor lifestyle
that future homeowners seek.

Leesville Crest – Fairmont Model, Raleigh NC
NanaWall Folding System SL45: standard aluminum framed
top-hung folding system





Loft's at River's East, Chicago IL
NanaWall Folding System SL60: **standard residential system,**
energy efficient, top-hung or floor supported



Differentiating Multifamily

NanaWall systems provides building owners, architects, property managers, homeowner associations, and contractors with a solution for increasing usable space, enhancing each unit's value and the marketability of the entire development.

- Respond to consumer demand and differentiate the multifamily property from others on the market by creating a greater sense of space through the use of NanaWall opening glass walls on balconies, porches, and even Juliet balconies.
- Benefit from high wind load and air-and-water infiltration performance making NanaWall systems suitable for high rise applications.



A Manor Garden Apartment, Hoboken NJ
NanaWall Folding System SL60: **standard residential system,**
energy efficient, top-hung or floor supported

B Justison Landing, Wilmington DE
NanaWall Folding System SL60: **standard residential system,**
energy efficient, top-hung or floor supported

Control Construction Costs

NanaWall Floor Supported Technology Option

NanaWall offers folding glass walls in both top-hung and floor supported options. We are able to recommend the best choice for each project.

- Floor supported systems offer the same weather protection, performance, and testing as expected from our top-hung systems.
- Floor supported systems are durable and offer smoother operation with stainless steel wheels on a stainless steel track.
- Floor supported systems offer easier height adjustability should building movement occur—be it from heavy snow loads or building settling over time.



Horizontal and Vertical Hinge Adjustment

Stainless Steel Wheels on a Stainless Steel Track

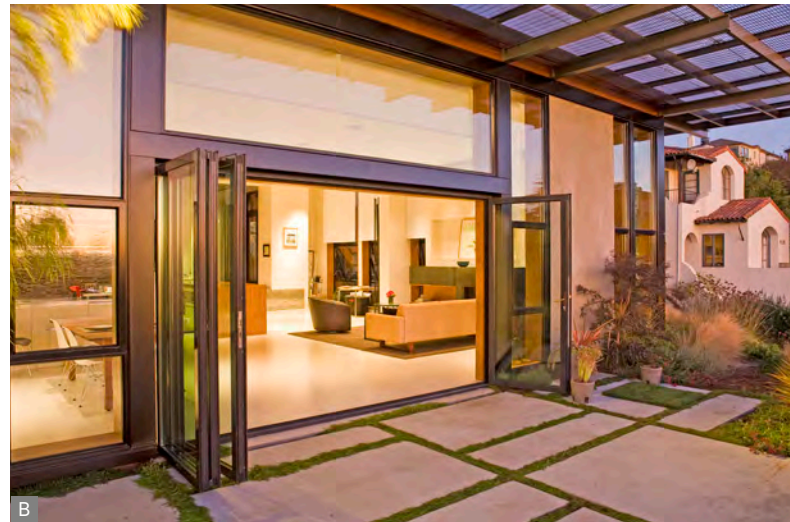

A Shea Homes at Jubilee, Lacey WA
NanaWall Folding System SL60: **standard residential system, energy efficient, top-hung or floor supported**

B Berkeley Residence, Berkeley CA
NanaWall Folding System SL60: **standard residential system, energy efficient, top-hung or floor supported**

Screening Systems

Screen ONE

Screen ONE is a fully retractable, non-pleated screening option with minimal verticals made of ultra-strong, UV resistant fiberglass mesh housed in a single cartridge riding on a single track.

Screen Classic

Screen Classic is a series of collapsible pleated screen panels. The screen cassettes can be joined to cover openings up to 40' and are magnetically secured.

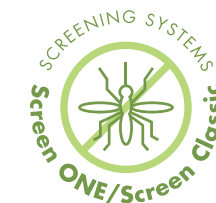

A Northbrook Residence, Northbrook IL
NanaWall Folding System SL60: **standard residential system with Screen ONE, energy efficient, top-hung or floor supported**

B Jamestown Residence, Jamestown NY
NanaWall Folding System SL60: **standard residential system with Screen Classic, energy efficient, top-hung or floor supported**

Extreme Weather Protection

Hurricane Resistant Folding Glass Wall

The NanaWall Folding System SL73 provides is specifically designed and engineered to perform in hurricane climates, eliminating the need for unsightly hurricane shutters.



Superstorm Sandy

On October 29, 2012 Long Island was hit hard by Superstorm Sandy. Despite major damage sustained by our house, the NanaWall system held firm! The glass was not broken, the frame was not damaged, and the door remained closed and secure. We were amazed!

—Jacqueline Z., Homeowner



The NanaWall held firm against Hurricane Sandy. The homeowners rebuilt with two NanaWall Folding Systems SL73—one inward and one outward opening.





High Security Applications

NanaWall BEARricade

Bear Resistant Folding Glass Wall

If your home is in an area that is near forested land, chances are you have bears as neighbors. A thrilling sight to see outside your home, a bear is less than charming when it's trying to have dinner in your home. Bears learn how to enter homes by simply using their immense strength and weight to push open French doors, windows, and even pushing in or breaking the glass on typical sliding glass doors.

With the BEARricade, you'll enjoy all of the attributes a NanaWall opening glass wall offers but when closed, the glass wall provides unequalled weather protection, security, and defense from bears.



A Wapiti House, Wapiti Valley WY
NanaWall Folding System SL70: large opening, highly energy efficient, floor supported system



Unique NanaWall Solutions

Yorba Linda Residence, Yorba Linda CA
NanaWall Folding System WD65 FoldFlat: wood framed top-hung system, panels fold flat against the wall

Open Corners
Create dramatic open corners requiring no structural post.

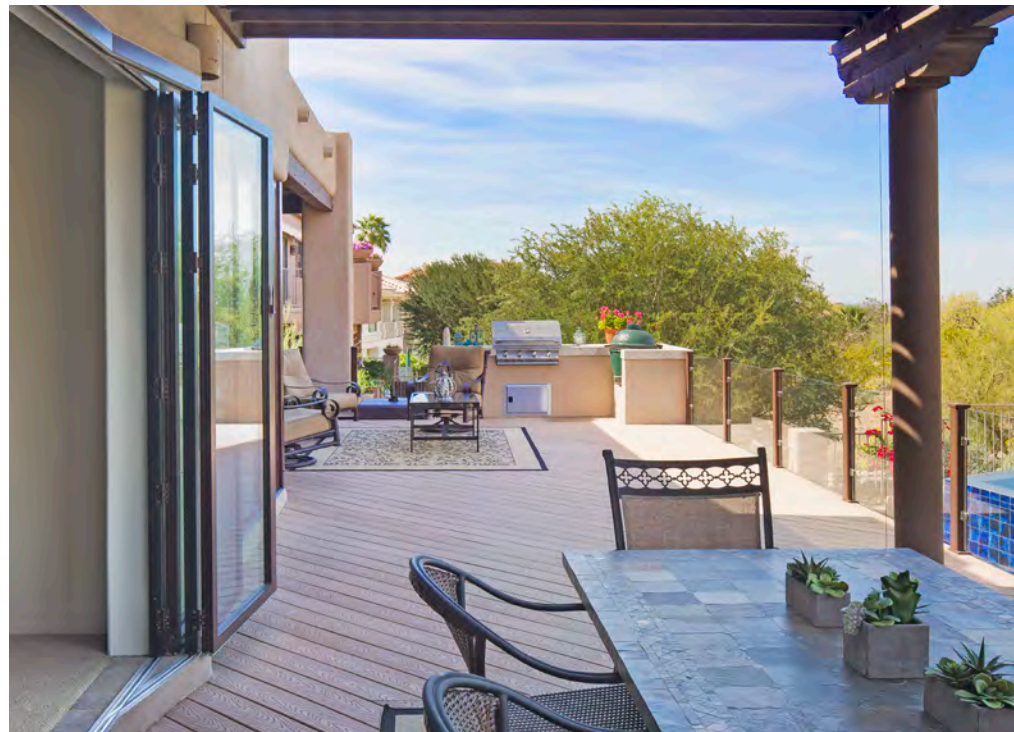

NanaWall FoldFlat®
The panels fold and stack parallel to the opening against the wall.

It doesn't stop here!





Visit [NanaWall.com](https://www.nanawall.com) and search KITCHEN for more kitchen projects

Belvedere Residence, Belvedere CA
NanaWall Folding System WD66: wood framed window/door combination, top-hung system



NanaWall Reinvents Kitchens

The Kitchen Transition adds versatility to kitchens without adding additional square feet.

The NanaWall Kitchen Transition is a combination of the company's opening glass windows and opening glass walls. The window/wall combination is an innovative way to enjoy the benefits and beauty of an outdoor kitchen, without the pricey redundancy.

Kitchen Transition Folding System

The window and wall portions of the Kitchen Transition open and operate independently; any combination can be created for virtually any kitchen that faces a backyard, courtyard or deck.

Kitchen Transition Single Track Sliding System

The innovative single track sliding system features a dual-height window/door combination with the option of zero floor track (for pristine countertops) and hidden pocketed panels.



A Seattle Kitchen, Seattle WA
NanaWall Folding Glass Wall WA67: aluminum clad wood framed folding system, top-hung system

B Federal Heights Residence, Salt Lake City UT
NanaWall Single Track Sliding System HSW60: energy efficient individual top-hung sliding aluminum panels, unlimited parking capabilities



Wide Range of Products

	Max Height	Unlimited Width	Mounting		Swing Door	Inswing / Outswing Possible	Inward / Outward in Same Unit	High Rise Capable
			Top-Hung	Floor Supported				
FOLDING SYSTEMS								
ALUMINUM								
SL45	9' 6"	■	■		■	■	■	
SL60	9' 10"		■	■	■	■		■
SL70	12'			■	■	■		■
SL73	10'			■	■	■		■
SL80/81	10'			■	■	■		■
SL82	8' 2"			■	■	■		
WOOD AND CLAD								
WD65	10' 3"	■	■		■	■	■	
WD66	9' 10"		■	■	■	■		■
WA67	9' 10"	■	■	■	■	■		■
SLIDING SYSTEMS								
ALUMINUM								
HSW60	12'	■	■		■	■		■
WOOD								
HSW66	10'	■	■		■	■		
HSW66 SwingSlide	10'	■	■		■	■		

FoldFlat	Kitchen Transition	Segmented Curves	Paired Panels	Center Pivot	Window Heights	Thermally Efficient NFRC Rated	Triple Glaze	Miami-Dade AAMA Hurricane	Edge-to-Edge Glass	Adjustable Features	Screens
FOLDING SYSTEMS											
ALUMINUM											
■	■	■	■	■	■					■	■
	■				■	■	■			■	■
	■	■			■	■	■			■	■
					■	■		■		■	■
					■	■	■			■	■
					■	■	■		■	■	■
WOOD AND CLAD											
■	■	■	■	■	■	■	■			■	■
	■				■	■	■			■	■
	■		■		■	■	■			■	■
SLIDING SYSTEMS											
ALUMINUM											
	■	■			■	■	■			■	■
WOOD											
	■	■			■	■	■			■	■
					■	■	■			■	■

NanaWall Features & Options

Standard 50 Finishes for Aluminum and Clad Systems

50 standard colors are available in powder coat and anodized finishes. For accurate color swatch examples, please request our Powder Coating Finish Options brochure.

STANDARD POWDER COAT OPTIONS



Glazing Area Options

- Glazing options include insulated, low-E, argon filled triple insulated low-E, bird protection glass, turtle glass, Heat Mirror, impact, and other specialty glass.
- Custom layouts with horizontal mullions, simulated divided lites, inserts, and high bottom rails are possible.

Wood Finish Options for WD65, WD66, and WA67

Standard woods include Douglas Fir, Pine, Spruce, and Meranti. Oak, Sapeli Mahogany and other specialty woods are available upon request, please consult NanaWall for additional costs. For accurate wood representation, please request our Wood & Finish Options brochure.

SELECT WOOD FINISH OPTIONS



*Available with upcharge.



Hardware Options

The standard locking hardware is compatible with a wide array of commercially available handle sets and escutcheon plates to match any design style.

Performance Features for Aluminum Framed Folding Systems

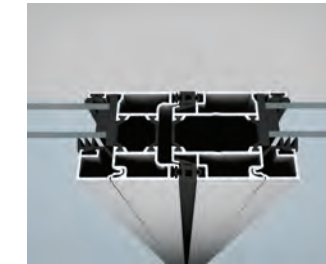

Weather Resistance

Double gaskets provide weather resistant comfort. The superior thermal break design maximizes interior energy efficiency whatever the weather extreme.



Long-Term Performance

Built-in adjustment and compensation points ensure continued ease of operation if some building settling occurs.

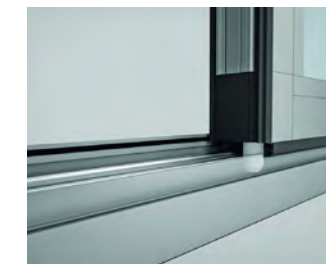

Multi-Point Locking

Concealed multi-point locking operates with the turn of a handle. The top and bottom shoot bolts have approximately a 1" (25 mm) throw for maximum security.



Swing Door Options

Convenient swing entry doors may be hinged to a side jamb or be configured within the chain of panels.

Panel Heights and Widths

All NanaWall Opening Glass Walls are custom made in the United States or Germany to your requirements and specifications.



Folding Systems

- Up to 12' (3660 mm) and widths of 4' (1220 mm) are possible depending on configuration and model.



Single Track Sliding Systems

- Up to 12' (3660 mm) and widths of 4' (1220 mm) are possible depending on configuration and model.
- Panels widths of up to 5' (1525 mm) x 10' (3050 mm) are also possible.**

Over 50 Standard Configurations

System configurations are possible with inward and outward openings. For easy entry/egress, locking swing panels may be attached to a side jamb or attached to the end of a chain of bi-fold panels.

MODEL:

This chart shows inward opening configurations with most panels folded to the right. **The exact mirror configurations can be achieved with the majority of the panels folded to the left.** The same configurations are also available outward opening. See chart at right for all 4-panel possibilities.

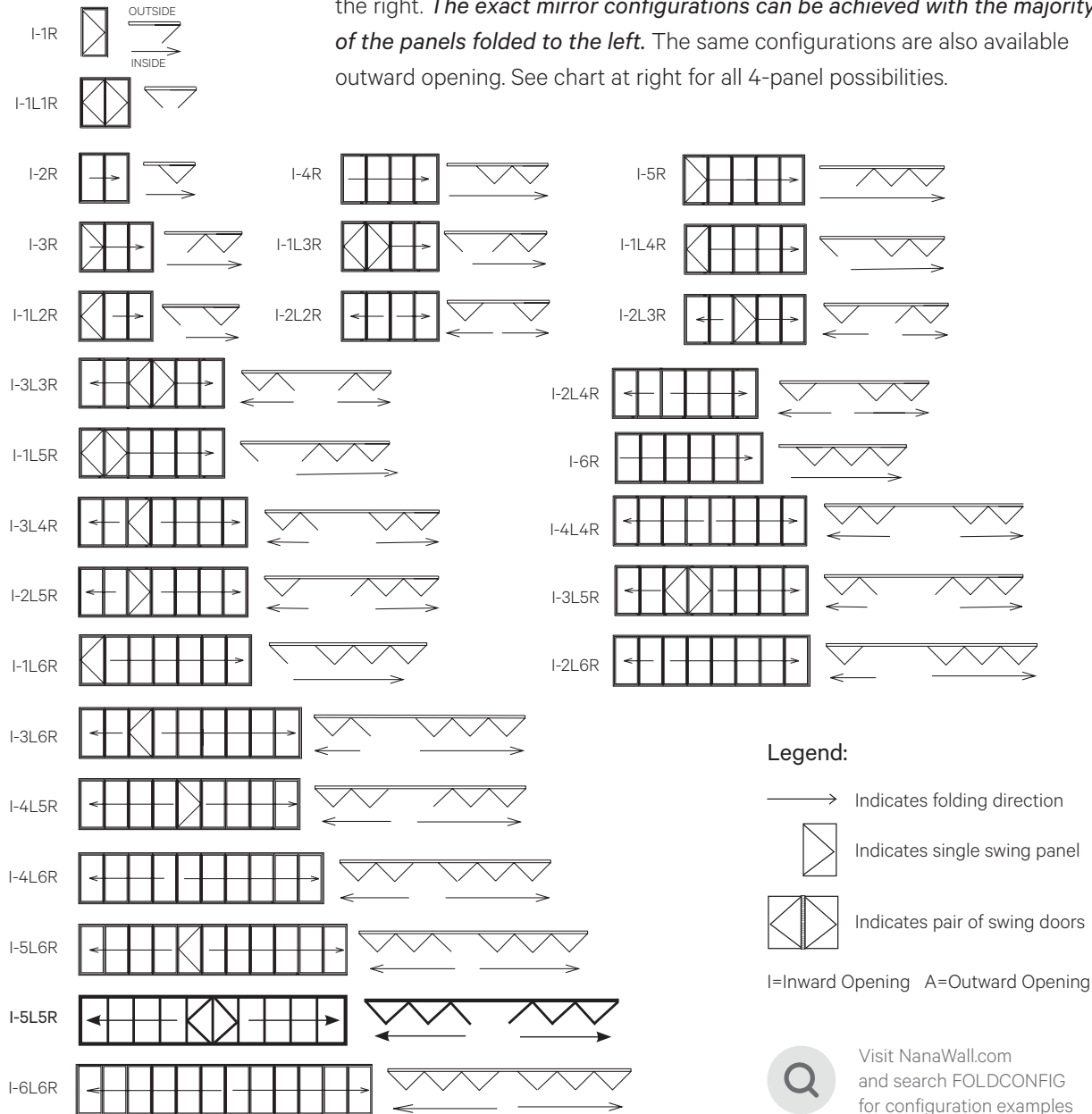

4-Panel Folding System Basic Configurations

Similar configurations are possible with other numbers of panels.

SYMMETRIC SOLUTION

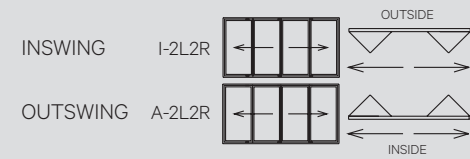

PAIR OF SWING DOORS SOLUTION

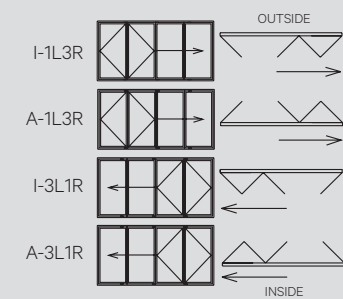

ALL PANELS FOLDING TO ONE SIDE

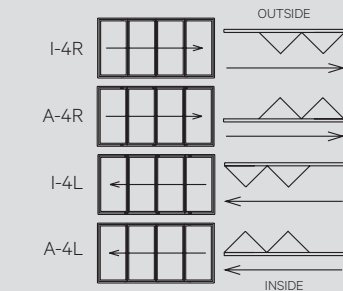

INWARD / OUTWARD

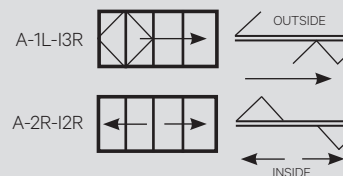

Sill Options*

Low Profile Saddle Sill
(inswing or outswing)

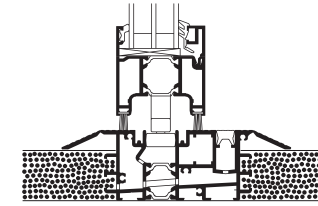

Higher Weather Performance Sill
(inswing)

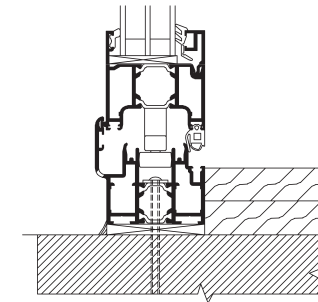

Higher Weather Performance Sill
(outswing)

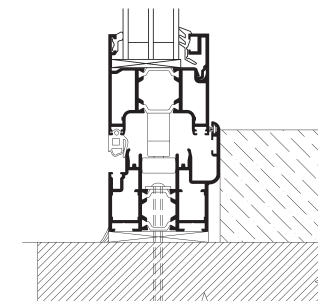

*Shown are SL60 folding systems sill examples. Similar sill options are available on most systems. Please contact NanaWall for available options.

Performance—NFRC tested and labeled (with higher weather performance sill)



U-Value as low as 0.17
(R-Value of 5.88)



Air Infiltration as low as:
@1.57 psf: 0.02**
@6.24 psf: 0.07**



Water Rating as high as:
No uncontrolled water entry at 12 psf**



Design Wind Load as high as:
Positive @70 psf**
Negative @100 psf**



Outdoor / Indoor Sound Transmission
OITC up to 35**

** Performance results vary per system. Please consult NanaWall for specific performance results for each model and configuration.





- NanaWall opening glass walls are sold factory direct through local architectural design representatives across North America. Our Certified Installation Network option ensures correct installation with speed and precision.
- From design to installation—we're here to help. Our Dedicated Design Team can answer your questions and assist with planning, ordering and optimizing your NanaWall options.

THE ONE AND ONLY NANAWALL

NanaWall redefined the category of opening glass wall systems. During our 25-plus years in business, we have earned the trust of architects, builders, design professionals, and homeowners as a solutions provider for re-imagining how buildings, people, and the elements interact. By combining precision engineering and outstanding design options across more than 20 unique systems, we advance design possibilities beyond the conventional for almost any space.